

PRODUCT DATASHEET

Spot Set Recess GU10 Dim Adjustable Click 6W 827 Red Brass

LED Spot Set Recess GU10 Dim | Recess with dimmable GU10 bulb included

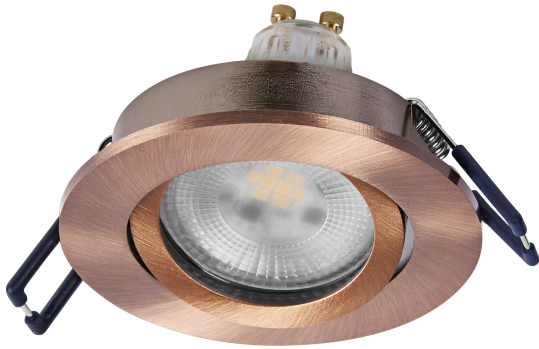

Areas of application

- Living areas (living rooms, dining rooms, bedrooms etc.)

Product benefits

- Can be rotated and swiveled for optimum illumination
- Sustainable solution thanks to exchangeable light sources
- Through-wiring possible with included connector box
- Easy mounting

Product features

- Recessed ceiling mounting
- Dimmable (with suitable Phase-cut dimmers)
- GU10 lamp included
- Adjustable swivel angle
- Color temperature: 2,700 K
- Through wiring possible
- Type of protection: IP20



TECHNICAL DATA

Electrical data

Nominal wattage	6.00 W
Nominal voltage	220...240 V
Mains frequency	50...60 Hz
Nominal current	34.000 mA
Power factor λ	> 0.5
Protection class	II
Operating mode	Mains voltage

Photometrical data

Luminous flux	500 lm
Total luminous flux of contained light sources	575 lm
Luminous efficacy	83 lm/W
Color temperature	2700 K
Light color (designation)	Warm White
Color rendering index Ra	≥80
Standard deviation of color matching	6 sdcn
Flickering metric (Pst LM)	<1
Stroboscope effect metric (SVM)	<0.4
Beam angle	40 °

Dimensions & Weight

Diameter	85.00 mm
Height	25.00 mm
Product weight	153.00 g

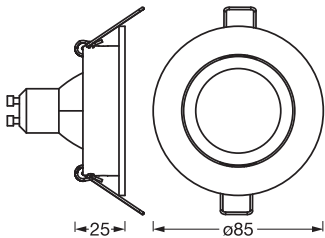

SP SET ADJCLICK
6W827DIMGU10

Materials & Colors

Body material	Aluminum
Glow Wire Test according to IEC 60695-2-12	650 °C

Application & Mounting

Ambient temperature range	-20...+40 °C
Temperature range at storage	-20...+80 °C
Type of connection	Terminal, 2-Pole (L, N)
Type of protection	IP20
Dimmable	Yes
Type of dimming	PHASE CUT
Mounting type	Recessed
Mounting location	Ceiling
Application environment	Indoor
Mounting diameter	68 mm
Mounting depth	100 mm
With light source	Yes
Replaceable light source	No
Holder designation	GU10

Lifespan

Lifespan L70/B50 at 25 °C	25000 h ¹⁾
Number of switching cycles	100000

1) t[h]: L70 / B50 @ 25 °C (Ta), t[h]: L80 / B10 @ 25 °C (Ta), t[h]: L90 / B10 @ 25 °C (Ta)

Emergency lighting

Type of emergency operation test	None
----------------------------------	------

Certificates & Standards

Standards	CE / UKCA
Luminaire with limited surface temperature, "D sign"	No

Additional product data

Product remark	Available from October 2025
Number of illuminants	3





EQUIPMENT / ACCESSORIES

- GU10 Lamp holder + Connector Box

Safety advice

- Luminaire must be disconnected from mains during installation, maintenance and cover removal
- Check wall-ceiling for suitability. If uncertain, seek professional advice.
- All electrical connections must be made by a qualified person.
- Caution, risk of electric shock.

DOWNLOAD DATA

Documents and certificates		Document name
	User instruction / safety instructions	Spot Set Adjustable Click
	Legal information	Safety insert G11222465
	Legal information	SPOT SET
	Declarations of conformity	CE Declaration Spotlights
	Declarations of conformity UKCA	UKCA Declaration Spotlights

LOGISTICAL DATA

Product code	Packaging unit (Pieces/Unit)	Dimensions (length x width x height)	Gross weight	Volume
4058075853577	Folding box 3	83 mm x 108 mm x 304 mm	509.00 g	2.73 dm ³
4058075853584	Shipping box 18	347 mm x 187 mm x 329 mm	3461.00 g	21.35 dm ³

The mentioned product code describes the smallest quantity unit which can be ordered. One shipping unit can contain one or more single products. When placing an order, for the quantity please enter single or multiples of a shipping unit.

DISCLAIMER

Subject to change without notice. Errors and omission excepted. Always make sure to use the most recent release.