

PRODUCT DATASHEET

Spot Set Recess GU10 Adjustable 4.5W 827 Satin Nickel

LED Spot Set Recess GU10 Adjustable | Recess swivel head with GU10 bulb included



Areas of application

- Living areas (living rooms, dining rooms, bedrooms etc.)

Product benefits

- Excellent price/performance ratio
- Can be rotated and swiveled for optimum illumination
- Sustainable solution thanks to exchangeable light sources
- Easy mounting

Product features

- Recessed ceiling mounting
- Adjustable swivel angle
- GU10 lamp included
- Color temperature: 3,000 K
- Type of protection: IP20



TECHNICAL DATA

Electrical data

Nominal wattage	4.50 W
Nominal voltage	220...240 V
Mains frequency	50...60 Hz
Nominal current	32.000 mA
Max. number of luminaires per miniature circuit breaker B16	206
Max. number of luminaires per miniature circuit breaker C16	263
Power factor λ	0.50
Protection class	II
Operating mode	Mains voltage

Photometrical data

Luminous flux	315 lm
Total luminous flux of contained light sources	400 lm
Luminous efficacy	61 lm/W
Color temperature	2700 K
Light color (designation)	Warm White
Color rendering index Ra	≥ 80
Standard deviation of color matching	6 sdc _m
Luminous intensity	150 cd
Flickering metric (Pst LM)	<1
Stroboscope effect metric (SVM)	<0.4
Photobiological safety group acc. to EN62778	RG1
Beam angle	36 °

Dimensions & Weight

Diameter	90.00 mm
Height	34.00 mm
Product weight	157.00 g

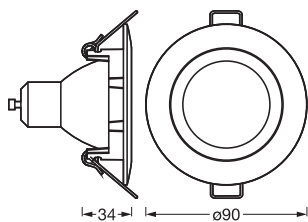

SP SET ADJ 4.5W 827 DEG96
GU10

Materials & Colors

Product color	Satin Nickel
Housing color	Satin Nickel
Body material	Aluminum
Glow Wire Test according to IEC 60695-2-12	650 °C

Application & Mounting

Ambient temperature range	-20...+40 °C
Temperature range at storage	-20...+80 °C
Type of connection	Terminal, 2-Pole (L, N)
Type of protection	IP20/IP20
Protection class IK (shock resistance)	IK03
Dimmable	No
Mounting type	Recessed
Mounting location	Ceiling
Mounting diameter	68 mm
Mounting depth	100 mm
With light source	Yes
Replaceable light source	No
Holder designation	GU10

Lifespan

Lifespan L70/B50 at 25 °C	25000 h ¹⁾
Number of switching cycles	100000

1) t[h]: L70 / B50 @ 25 °C (Ta), t[h]: L80 / B10 @ 25 °C (Ta), t[h]: L90 / B10 @ 25 °C (Ta)

Emergency lighting

Type of emergency operation test	None
----------------------------------	------

Certificates & Standards

Standards	CE / UKCA
Luminaire with limited surface temperature, "D sign"	No

Additional product data

Product remark	Available from January 2026
Number of illuminants	3





EQUIPMENT / ACCESSORIES

- GU10 Lamp holder + Connector Box

Safety advice

- Luminaire must be disconnected from mains during installation, maintenance and cover removal
- Check wall-ceiling for suitability. If uncertain, seek professional advice.
- All electrical connections must be made by a qualified person.
- Caution, risk of electric shock.

DOWNLOAD DATA

Documents and certificates		Document name
	User instruction / safety instructions	SP SET ADJ 4.5W 827 DEG96 GU10
	Legal information	Safety insert G11222465
	Legal information	Legal insert
	Declarations of conformity	CE Declaration Spotlights
	Declarations of conformity UKCA	UKCA Declaration Spotlights

LOGISTICAL DATA

Product code	Packaging unit (Pieces/Unit)	Dimensions (length x width x height)	Gross weight	Volume
4099854631733	Folding box 3	83 mm x 110 mm x 301 mm	559.00 g	2.75 dm ³

Product code	Packaging unit (Pieces/Unit)	Dimensions (length x width x height)	Gross weight	Volume
4099854631740	Shipping box 18	322 mm x 232 mm x 279 mm	3794.00 g	20.84 dm³

The mentioned product code describes the smallest quantity unit which can be ordered. One shipping unit can contain one or more single products. When placing an order, for the quantity please enter single or multiples of a shipping unit.

DISCLAIMER

Subject to change without notice. Errors and omission excepted. Always make sure to use the most recent release.